

Toon Sol
tlf 62 57 39 34 / 417 76 000
toon@braathenmek.no

tlf 62 57 60 00 faks 62 57 68 24
post@braathenmek.no
www.braathenmek.no

Ivar bråthen Mekaniske AS
Postboks 113, 2312 Ottrestad
Gubberudvegen 132, 2312 Ottrestad

Rekkverk Hedda Dobbelt

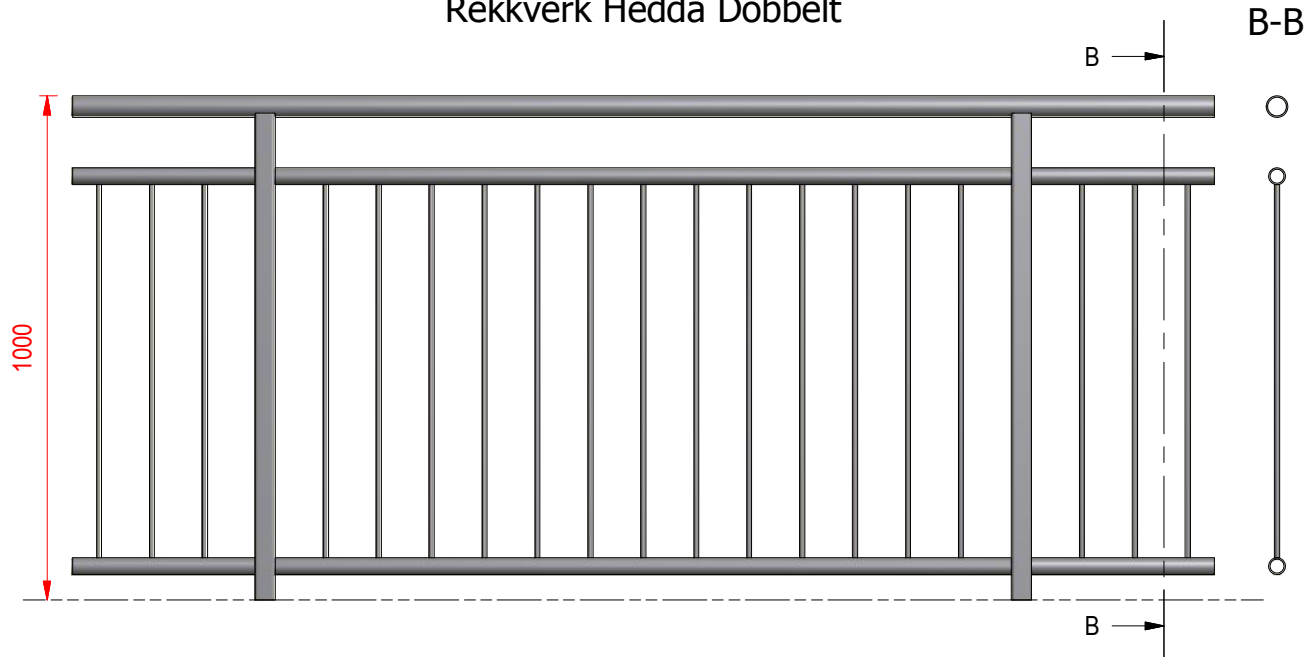

Rekkverk Hedda Enkelt

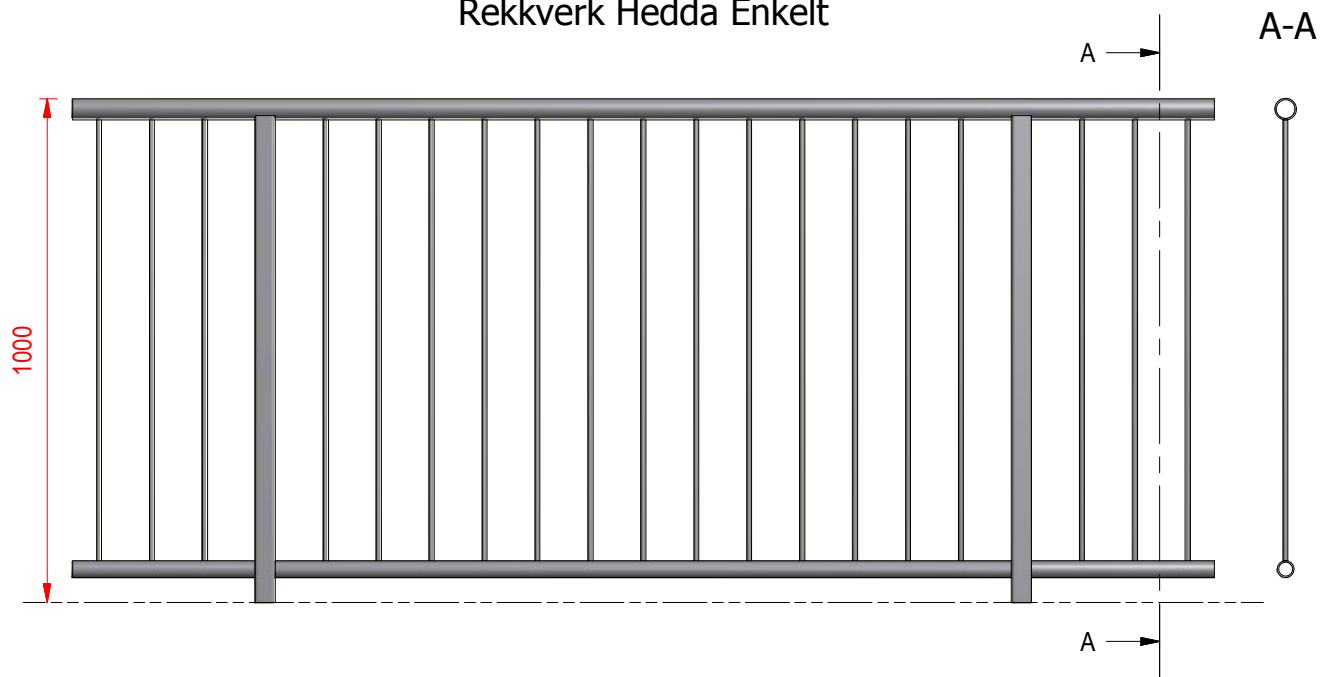

Materialer:

Stolpe : hup 40x40x3
Toppligger : rør 42.4 x 2.6
Mellomligger : rør 33.7 x 2.6
Spile : rundt 10

c/c stolper : ca. 1000-1500 mm
c/c spiler : 105 mm

Rekkverk Lena

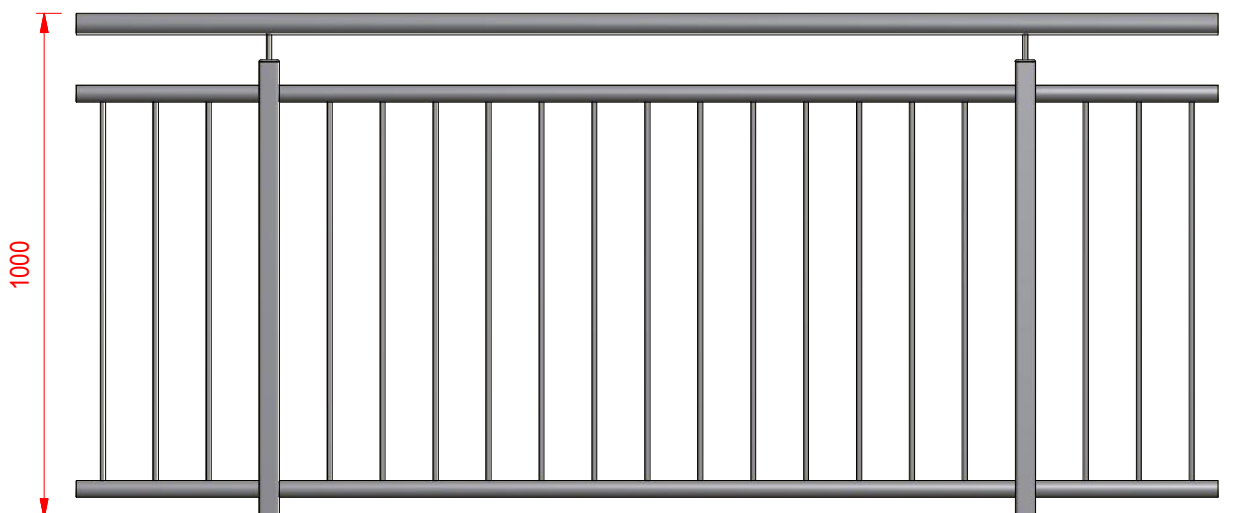

Toon Sol
tlf 62 57 39 34 / 417 76 000
toon@braathenmek.no

tlf 62 57 60 00 faks 62 57 68 24
post@braathenmek.no
www.braathenmek.no

Ivar bråthen Mekaniske AS
Postboks 113, 2312 Ottestad
Gubberudvegen 132, 2312 Ottestad

Materialer:

Stolpe	: hup 40x40x3
Toppligger	: rør 42.4 x 2.6 eller treverk
Mellomligger	: rør 33.7 x 2.6
Spile	: rundt 10
c/c stolper	: ca. 1000-1500 mm
c/c spiler	: 105 mm

Toon Sol
tlf 62 57 39 34 / 417 76 000
toon@braathenmek.no

tlf 62 57 60 00 faks 62 57 68 24
post@braathenmek.no
www.braathenmek.no

Ivar bråthen Mekaniske AS
Postboks 113, 2312 Ottestad
Gubberudvegen 132, 2312 Ottestad

Peder type S

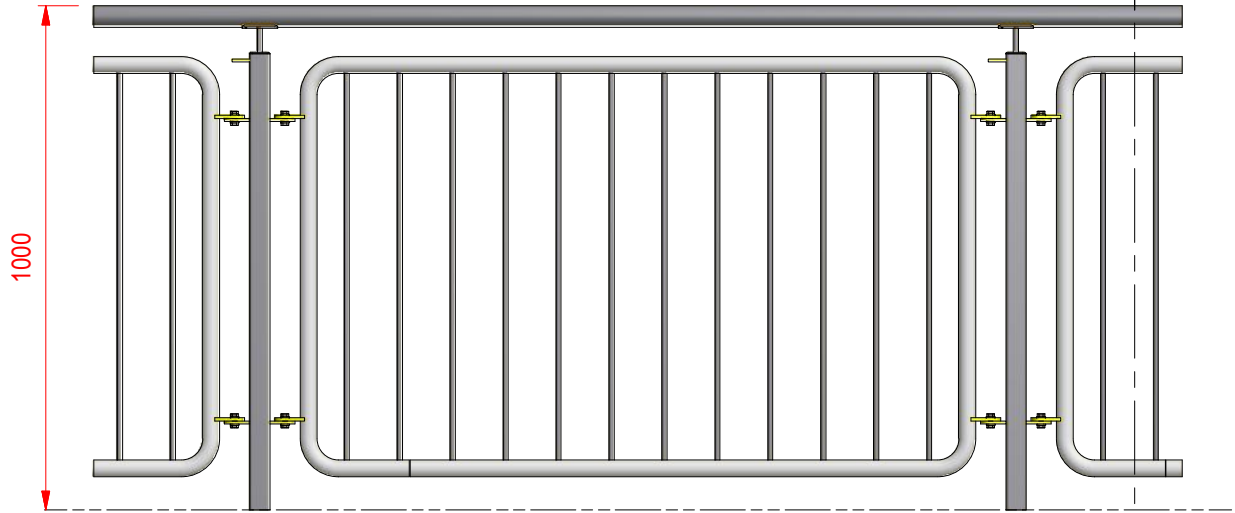

D-D



Peder type G

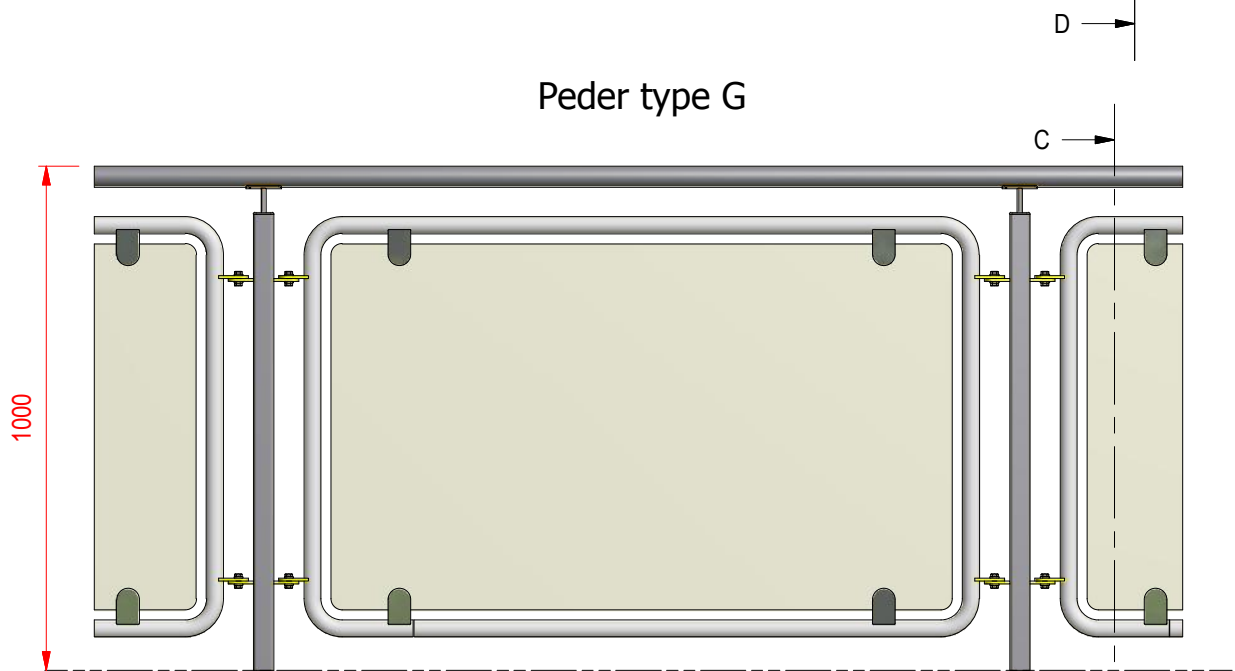

C-C

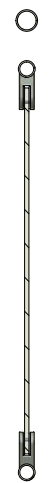

Peder type N

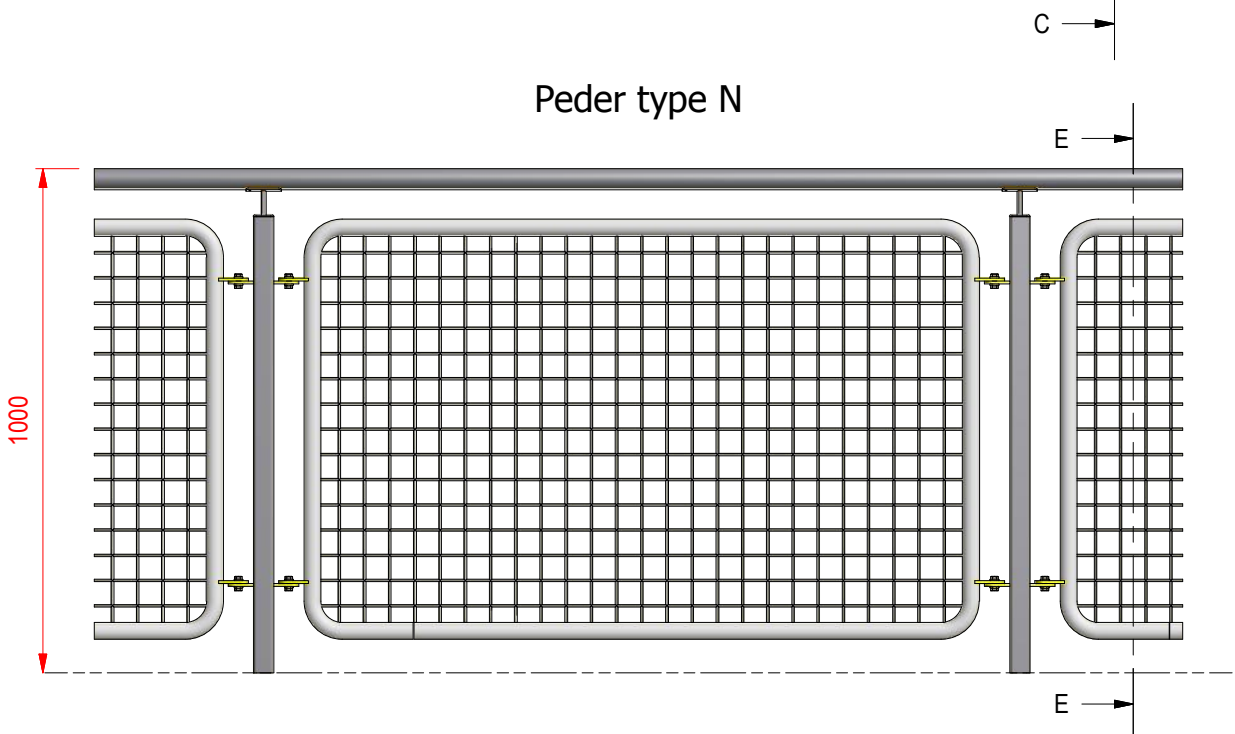

E-E



Toon Sol
tlf 62 57 39 34 / 417 76 000
toon@braathenmek.no

tlf 62 57 60 00 faks 62 57 68 24
post@braathenmek.no
www.braathenmek.no

Ivar bråthen Mekaniske AS
Postboks 113, 2312 Ottestad
Gubberudvegen 132, 2312 Ottestad

Kine type S

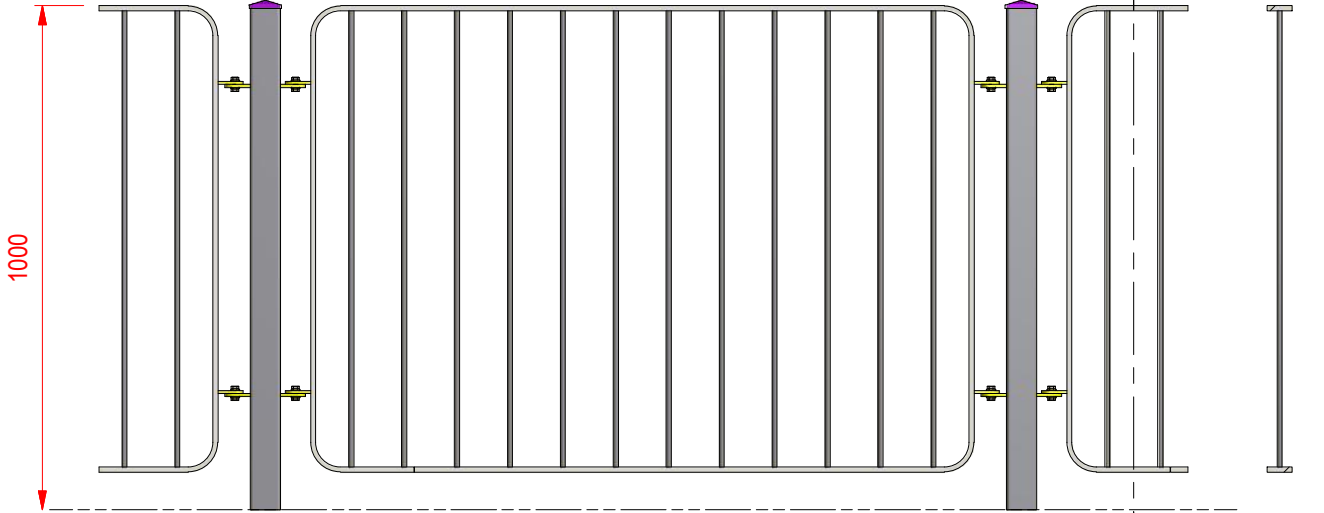

Kine type G

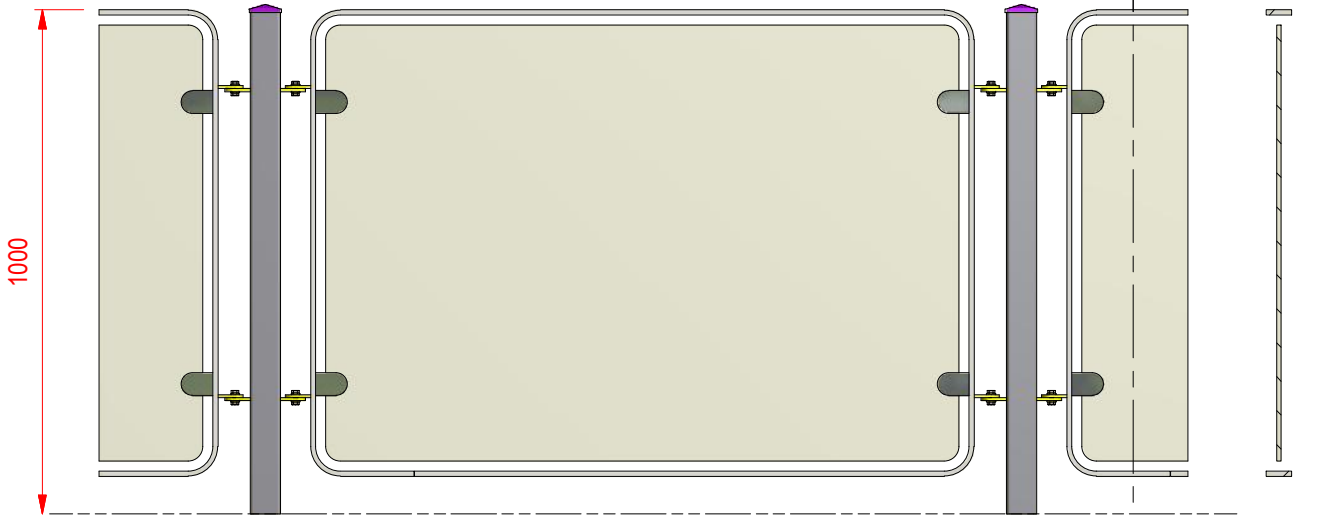

Kine type N

